

CYLINDRICAL

FUSE LINKS & FUSE HOLDERS/BASES



BAC

industrial open fuse bases
for cylindrical fuse links



10x38



14x51



22x58

**PROTECTING
THE WORLD**





RATED CURRENT

32A

RATED VOLTAGE

690V

MAXIMUM POWER DISSIPATION

8W

PROTECTION INDEX

IPO0

STANDARDS

IEC/EN 60269-1

IEC/EN 60269-2



Open type fuse bases for cylindrical fuse links

Industrial open fuse bases for industrial cylindrical fuse links size 10x38.

Specially suitable for semiconductor protection fuselinks that have a high dissipated power and need to be mounted on open fuseholders to facilitate the dissipation of heat.

Manufactured with a high quality materials

- Silver plated copper contacts.
- Plastic materials with high temperature resistance and self-extinguishable.
- All the materials are according to the European Directive RoHS.



For DIN rail mounting or with screw fixing.

Easy terminal connection.

Microswitch accessory for fuses with striker to monitor the fusion.

Manufactured according to IEC, EN standards.

Warning of use

Installing or replacing of fuse links is only allowed by instructed specialized staff.



To avoid electrical risk, install the switchgear without voltage.

Range

REFERENCE	DESCRIPTION	PACKING
451250	10x38 BAC FUSE BASE 1P	Uni /BOX 6/120



Technical data

Rated current	32A	
Rated voltage	690V	
Maximum power dissipation	8W	
Protection index	IP00	
Rated impulse withstand voltage	6kV	
Ambient temperature of service	-20°C ... 70°C	
Storage temperature	-40°C ... 80°C	
Correction of the admissible current in function of the temperature	20° C	1
	30° C	0,95
	40° C	0,90
	50° C	0,80
	60° C	0,70
	70° C	0,60

Dimensions

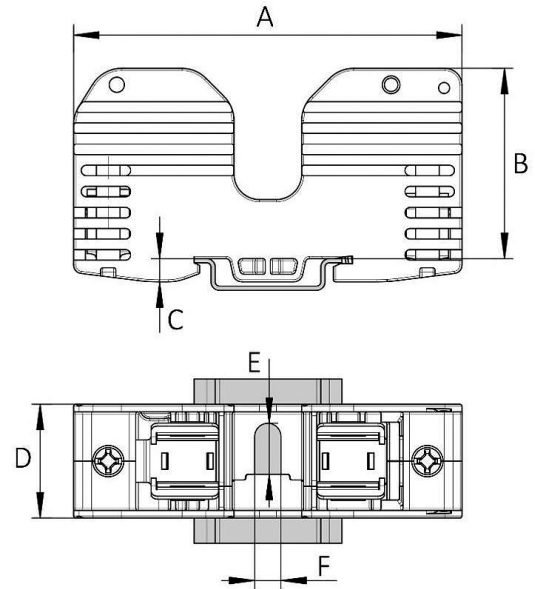

A	B	C	D	E	F
75	32,5	5,5	22	9	4,5

Weight 50gr

Standards

IEC/EN 60269-1
IEC/EN 60269-2



Application characteristics

Connecting wire

Copper wires only

METRIC	AWG	WIRING
0,75...25mm ² Solid	4.....18 AWG Solid	
0,75...16mm ² Stranded	6.....18 AWG Stranded	

Wire-end terminals

The use of wire-end terminals may allow to increase the connecting wire section.

Wire-end terminals recommended mounting:

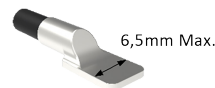

Ferrules

It's recommended use of ferrules in wires with section $\leq 2,5\text{mm}^2$



The product is delivered with the terminals opened and ready to connect

Tightening torque on terminals	2,5 Nm / 22 lb.in
Screws with a combined head	SLOT + PH2
Screw fixing	M4 - 3 Nm For a correct functionality, use washers

For mounting on DIN/EN standard rail DIN 46277/1-3 (EN50022)

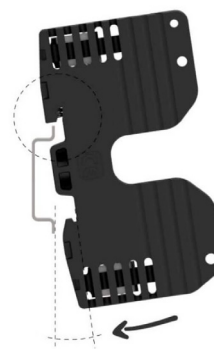

Insert the fuse holder on the DIN rail with a slight angle

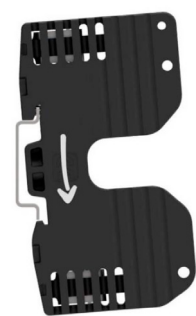

Fixed at the top, press down slightly to fix the bottom



The base is mounted on the rail.
To disassemble, perform the same operations in reverse.



The clamping spring must be positioned at the top of the DIN rail



HEAD OFFICE AND FACTORY

SILICI, 67-69
08940 CORNELLA DE LLOBREGAT
BARCELONA
SPAIN
Tel. +34 93 377 85 85
Fax +34 93 377 82 82

INTERNATIONAL SALES

Tel. +34 93 475 08 64
Fax +34 93 480 07 75
export@dfelectric.es

NATIONAL SALES

Tel. 93 475 08 64
Fax 93 480 07 76
comercial@dfelectric.es

dfelectric.es



The data reflected in this technical record are subject to the correct installation of the product in accordance with manufacturer's instructions, relevant installation standards and professional practices, maintained and used in applications for which they were made.

DF ELECTRIC retains the right to change the dimensions, specifications, materials or design of its products at any time with or without notice.

©2021 DF Electric. All rights reserved



PROTECTING THE WORLD

