

LCD Thermometer (non-waterproof) DE-20/DE-20W/DE-20C

- MAX / MIN DATA HOLD
- Easy monitoring 、 Easy carrying 、 Equipment temperature monitoring 、 Indoor/Outdoor use etc.



Features : Compact

- Maximum / Minimum Data Hold
- Resolution : 0.1°C
- Low Cost
- Measurement Temp. Range :
 - 50°C~100°C(DE-20W)
 - 10°C~70°C(DE-20)
- Accuracy : -50°C~40°C ± 1.8°C
>40°C~100°C ± 3.0°C
- Sampling Rate : every 10 seconds
- Over Range Indication : "Hi" or "Lo" display(DE-20W)
- Applicable Ambient Temp. for Meter: -10°C~70°C
- Battery Life Time : approx. 3 months
- Battery : Button Cell LR44 or Sr44 x 1 (installed)
- Low Battery Indication : display color fades away
- Dimension : 48(L) x28.6(W) x15.5(H)mm
- Weight : DE-20 : 14g , DE-20W : 26.2g approx.
- Only DE-20W is with an extension temp. probe that can work with the wider range. Don't apply DE-20 exceeding the measurement temp. range as the case of meter may crash while over the range.
- Optional models with water proof design - DE-30W (with cable) & DE-30 are available in our line.

Battery Replacement

DE-20W Extension wire sensor

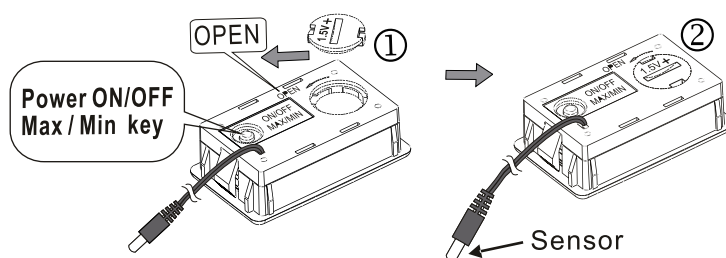

DE-20 Sensor embedded in case

